

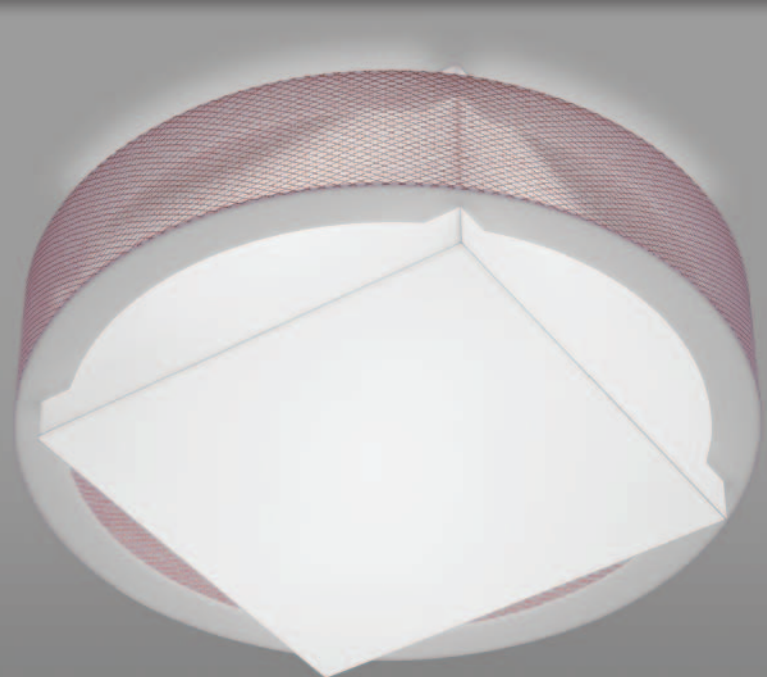

LAMINATED SURFACE DIFFUSERS



Custom 48-inch Fabric Pendant Bowl



Custom Fabricated Inner Box with Bronze Mesh Outer Shade



Custom Linear Die Cut Trim



CCDL18-563



CCFD15-557



Custom White with Brushed Nickel Trim

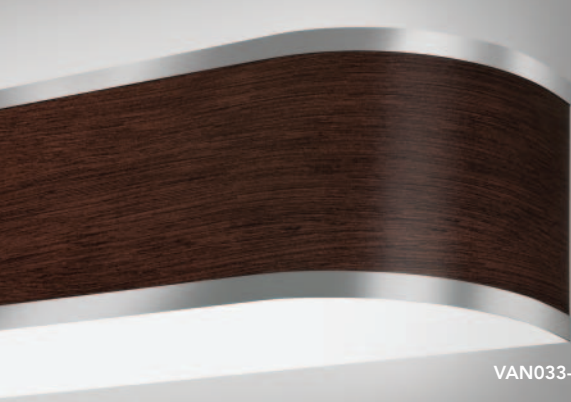

VAN033-B-559-BN



CCDL23-558

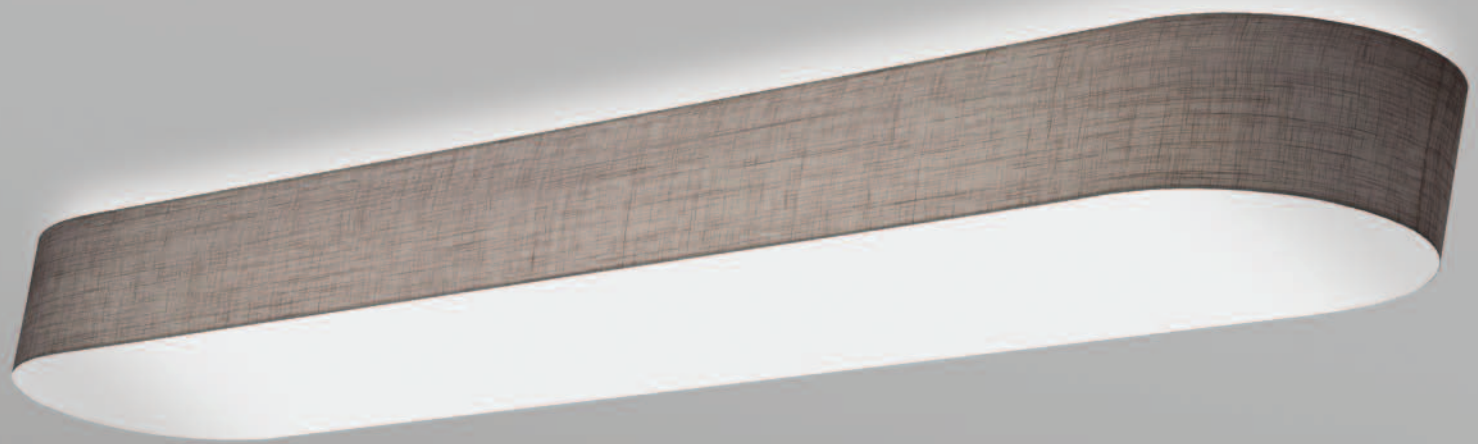

LIN031-G-556

RLR Industries, Inc. is proud to introduce our Laminated Surface Diffuser series components. These innovative decorative diffuser components allow the OEM to produce a luminaire that can be chosen with a variety of finishes that are laminated to the surface of the diffuser via a proprietary in-house application process.

Fabricated drums are available in round, linear and linear vanity design motifs. A formed decorative deep round saucer shape is also available. Applications for these products include restaurants, hotel & office lobbies, open office environments, hallways, and bath vanity installations. In addition the vanity units can be used for overbed luminaires for assisted living/healthcare applications.

Extremely large custom sized round drum shades can be fabricated up to a diameter of 60" and a depth of 20". The fabrication technique can also be applied to oval, cloverleaf and other styles/shapes of drums.

Free Formed and Hard Tooled Pendant Bowls and Domes in varying size diameters and depths can be produced using the laminated surface material. This can be quoted upon request.

The Laminated Surface Diffuser materials are lightweight, durable and washable, which makes the material an optimal choice for usage in luminaires in high traffic interior environments.

The accompanying color swatches display the choices available for the laminated surface finishes. In addition, custom patterns and custom laminated finishes can be developed per customer requests.



Single & Double Tier Drums



ORDERING INFORMATION

CCFS12-556 (example) 12" Single Tier Drum, Chocolate Linen Finish

Base Part Number: CCFS12 Single Tier Small Diameter
CCFS15 Single Tier Medium Diameter
CCFS19 Single Tier Large Diameter
CCFS24 Single Tier 24" Pendant Diameter
CCFS30 Single Tier 30" Pendant Diameter
CCFD12 Double Tier Small Diameter
CCFD15 Double Tier Medium Diameter
CCFD19 Double Tier Large Diameter
CCFD24 Double Tier 24" Pendant Diameter
CCFD30 Double Tier 30" Pendant Diameter

Surface Finish: 217 White Matte Acrylic 558 White Linen
553 Russell Square 559 Wenge
554 Louver Resin 560 Translucent Linen
556 Chocolate Linen 561 Grey Alabaster
557 Rapids 562 Digital Layered

Hardware: CCFHARD, Drum Mount Spacer kit bag, 1 kit bag to be ordered for each lens ordered.

Double Layer Drums



Note: Surface Finishes are on applied on the outer shade

ORDERING INFORMATION

CCDL16-563 (example) 16" Double Layer Drum, White Inner/Clear Outer

Base Part Number: CCDL16 Double Layer - Small Diameter
CCDL18 Double Layer - Medium Diameter
CCDL23 Double Layer - Large Diameter

Surface Finish: 217 White Matte Acrylic 559 Wenge
553 Russell Square 560 Translucent Linen
554 Louver Resin 561 Grey Alabaster
556 Chocolate Linen 562 Digital Layered
557 Rapids 563 White Inner/Clear Outer
558 White Linen

Hardware: CCFHARD, Drum Mount Spacer kit bag, 1 kit bag to be ordered for each lens ordered.

Formed Saucers



ORDERING INFORMATION

FSF18-554 (example) 18" Formed Saucer, Louver Resin Finish

Base Part Number: FSF18 Formed Saucer - Medium Diameter
FSF22 Formed Saucer - Large Diameter

Surface Finish: 217 White Matte Acrylic 558 White Linen
553 Russell Square 559 Wenge
554 Louver Resin 560 Translucent Linen
556 Chocolate Linen 561 Grey Alabaster
557 Rapids 562 Digital Layered

Trim Option: BN Brushed Nickel Trim, Top Edge
(Blank) No Trim

Hardware: CCFHARD, Drum Mount Spacer kit bag, 1 kit bag to be ordered for each lens ordered.

Linear Shades



ORDERING INFORMATION

LIN031-G-556 (example)	Nominal 4' long Linear Shade, Chocolate Linen Finish	
Base Part Number:	LIN031-G Linear Shade, Nominal 4' long LIN031-K Linear Shade, Nominal 2' long	
Surface Finish:	217 White Matte Acrylic 553 Russell Square 554 Louver Resin 556 Chocolate Linen 557 Rapids	558 White Linen 559 Wenge 560 Translucent Linen 561 Grey Alabaster 562 Digital Layered
Hardware:	LFSHKIT2L, Linear Drum Bracket kit bag, 1 kit bag to be ordered for each linear shade lens ordered	

Vanity

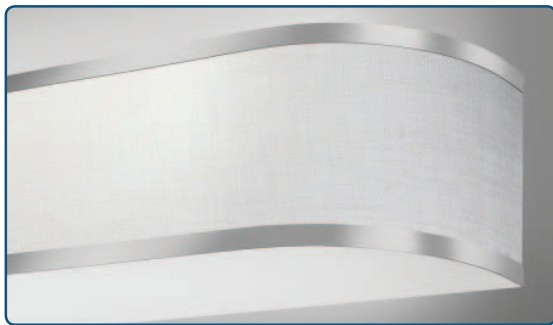

Note: Clearance Notch for pull chain/convenience outlet on bottom lens can be added per request for applications requiring access to these fixture features.

ORDERING INFORMATION

VAN033-A-558-BN (example)	Nominal 2' long Vanity, Vanilla Linen Finish, Brushed Nickel Trim Strips	
Base Part Number:	VAN033-A Vanity, Nominal 2' long VAN033-B Vanity, Nominal 3' long VAN033-C Vanity, Nominal 4' long	
Surface Finish:	217 White Matte Acrylic 553 Russell Square 554 Louver Resin 556 Chocolate Linen 557 Rapids	558 White Linen 559 Wenge 560 Translucent Linen 561 Grey Alabaster 562 Digital Layered
Trim Option:	BN Brushed Nickel Trim, Top & Bottom (Blank) No Trim	

Custom Cloverleaf Wenge Shade

Standard Sized Diffuser Dimensions:

RLR Base Part Number	Lens Style	Chassis Mount Guide	A	B	C	D	E
CCFS12	Single Tier Drum - Small Dia.	Flushmount - RLR C11PAN	12.25"	4.50"	-	-	-
CCFS15	Single Tier Drum - Medium Dia.	Flushmount - RLR C14PAN	15.00"	4.50"	-	-	-
CCFS19	Single Tier Drum - Large Dia.	Flushmount - RLR C19PAN	19.25"	5.25"	-	-	-
CCFS24	Single Tier - 24" Pendant Shade	Pendant Mount - Customer Provided	24.00"	8.00"	-	-	-
CCFS30	Single Tier - 30" Pendant Shade	Pendant Mount - Customer Provided	30.00"	8.00"	-	-	-
CCFD12	Double Tier Drum - Small Dia.	Flushmount - RLR C11PAN	12.25"	6.38"	8.00"	4.50"	1.88"
CCFD15	Double Tier Drum - Medium Dia.	Flushmount - RLR C14PAN	15.00"	6.38"	10.00"	4.50"	1.88"
CCFD19	Double Tier Drum - Large Dia.	Flushmount - RLR C19PAN	19.25"	6.38"	12.25"	4.50"	1.88"
CCFD24	Double Tier - 24" pendant Shade	Pendant Mount - Customer Provided	24.00"	9.75"	15.00"	5.25"	4.50"
CCFD30	Double Tier - 30" Pendant Shade	Pendant Mount - Customer Provided	30.00"	9.75"	19.25"	5.25"	4.50"
CCDL16	Double Layer Drum - Small Dia.	Flushmount - RLR C11PAN	16.00"	5.25"	-	-	-
CCDL18	Double Layer Drum - Medium Dia.	Flushmount - RLR C14PAN	18.00"	5.25"	-	-	-
CCDL23	Double Layer Drum - Large Dia.	Flushmount - RLR C19PAN	23.25"	5.25"	-	-	-
FSF18	Formed Saucer - Medium Dia.	Flushmount - RLR C14PAN	18.00"	4.40"	-	-	-
FSF22	Formed Saucer - Large Dia.	Flushmount - RLR C19PAN	22"	5"	-	-	-
LIN029-K	Linear Drum - Nominal 2' Long	3.00" Nominal Wide Strip	8.50"	28.50"	4.50"	4.50"	-
LIN029-G	Linear Drum - Nominal 4' Long	3.00" Nominal Wide Strip	8.50"	52.50"	4.50"	4.50"	-
VAN033-A	Vanity - Nominal 2' Long	3.00" Nominal Wide Strip	30.00"	5.00"	5.43"	21.375"	-
VAN033-B	Vanity - Nominal 3' Long	3.00" Nominal Wide Strip	42.00"	5.00"	5.43"	33.375"	-
VAN033-C	Vanity - Nominal 4' Long	3.00" Nominal Wide Strip	54.00"	5.00"	5.43"	45.375"	-

Linear Shades

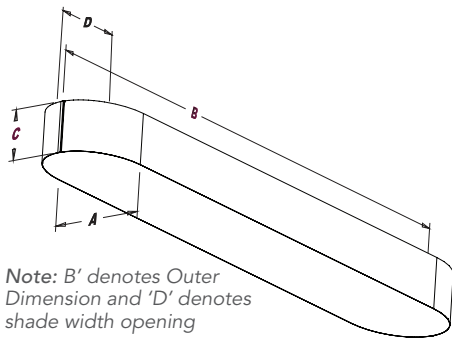

Formed Saucer

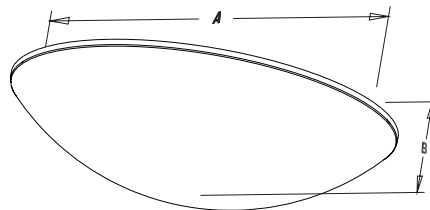

Vanity

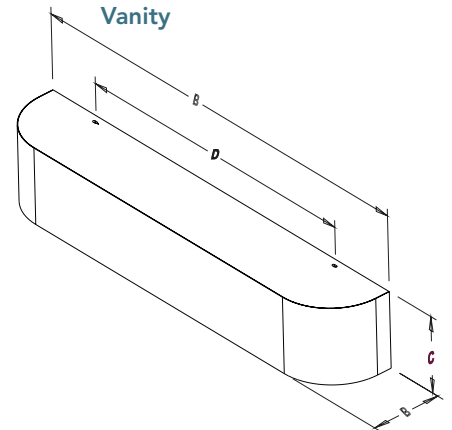

Single Tier Drum

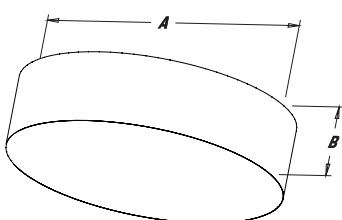

Double Tier Drum

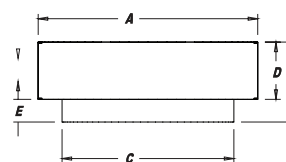
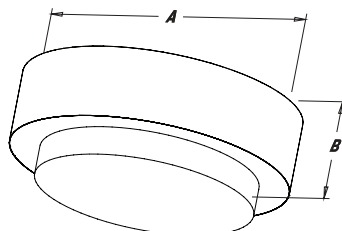

Double Layer Drum

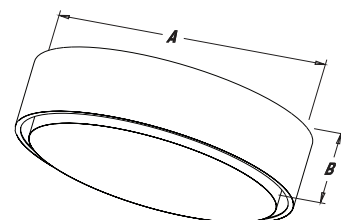



CCDL23 Custom Black Mesh Fabric

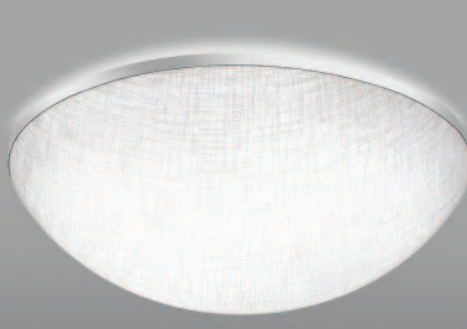

FSF18-558-BN



CCFS15-556



CCFD30-553 Pendant



Custom Drum with Angled Mesh Outer Tier Shade



VAN003-C-558-BN



CCFS19 Custom Die Cut Web Trim

LAMINATED SURFACE DIFFUSERS

Standard Laminated Finishes

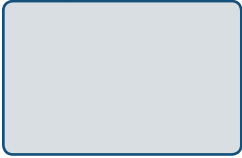

217 White Matte Acrylic

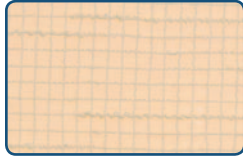

553 Russell Square

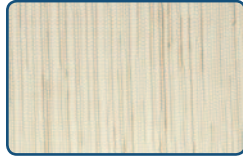

554 Louver Resin

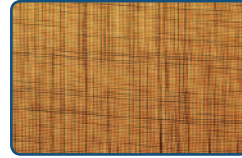

556 Chocolate Linen

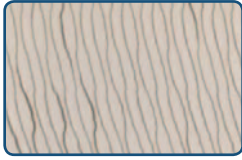

557 Rapids



558 White Linen

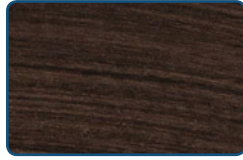

559 Wenge

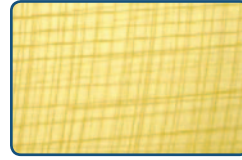

560 Translucent Linen



561 Grey Alabaster



562 Digital Layered



563 White Inner/
Clear Outer

Trim Finish



BN Brushed Nickel



RLR
INDUSTRIES, INC.

Dimensions and specifications contained in this sheet are subject to change without notice. Colors illustrated on this sheet are digital photographs and rendered representations. True color representation can be confirmed upon request with a sample swatch order.

RLR Industries, Inc.

Since 1957, RLR Industries, Inc. has been manufacturing plastic lenses and diffusers for the lighting industry. In addition, the firm has performed custom forming and fabrication services for many diverse industries.

Over the years, our capabilities have expanded from our core capabilities of thermoforming and fabricating plastic sheet products to injection molding, CNC fabrication and flat sheet extrusion.

Our modern 100,000 square foot facility in Mableton, Georgia contains state of the art plastics processing equipment. Our commitment to manufacturing demands that we constantly research and implement the latest cost effective technologies in our manufacturing operation.

RLR maintains an in house tooling staff to produce our vacuum and pressure forming tooling, as well as all associated fabrication jigs and fixtures. We also maintain our injection molds in house. We have the ability to source high quality injection molds through a time-tested network of tooling suppliers.

RLR maintains a stock tooling list, as well as performing custom product development and production for lighting OEMs. All proprietary OEM work is held on a confidential basis for our customers.

We have stocking warehouses in strategic areas of the United States and maintains a just-in-time service on our stock items for our customers from our Mableton, GA facility. In addition, RLR maintains just-in-time stock for custom products on a contract basis for our customers.

The Mableton, Georgia facility is conveniently located 20 minutes from Atlanta's Hartsfield International Airport and is within 5 minutes from major interstate routes. We welcome our customers to visit us at your convenience to discuss your custom plastic requirements.

Privately held, the Lewis family, now in their second generation of serving the lighting industry, is dedicated to continue to serve your thermoforming, injection molding, and fabrication needs.



575 Discovery Place • Mableton, GA 30126 • 770.948.6069

www.rlrandinc.com

04/2013